

FILED
 1981 MAR 13 3 06 PM '81
 DONNIE W. HANNESLEY
 R.M.C.

NO.	RADIUS	ARC	DELTA	CHORD	BEARING	TANGENT
59	275.00	49.00	10-12-33	48.94	S18-13-53W	24.57
60	275.00	80.29	16-43-38	80.00	S32-01-53E	40.43
61	275.00	47.01	09-47-36	46.95	S45-17-35E	23.58
62	50.00	63.25	72-28-29	59.11	S26-25-38E	36.65
63	50.00	60.83	69-42-03	57.14	S82-29-06E	34.82
64	50.00	57.71	66-08-01	54.56	N14-34-04E	32.55
65	50.00	80.02	91-41-27	71.75	N64-20-40W	51.50
66	225.00	95.11	24-13-07	94.40	S38-04-50E	48.27
67	225.00	49.13	12-30-40	49.03	S19-42-56E	24.66
68	225.00	43.44	11-03-56	43.38	S82-04-17W	21.79
69	225.00	127.71	32-31-13	126.00	N76-08-14W	65.63
70	225.00	128.75	32-47-09	127.00	N43-09-03W	66.19
71	225.00	38.05	09-41-17	38.00	N22-14-50W	19.07
72	50.00	49.69	56-56-24	47.67	S34-57-16W	27.11
73	50.00	50.35	57-41-40	48.25	S22-21-47E	27.54
74	50.00	59.25	67-53-59	55.85	S85-09-37E	33.66
75	50.00	76.33	87-27-56	69.13	N17-09-26E	47.84
76	275.00	120.42	25-05-21	119.46	S29-56-52E	61.19
77	225.00	40.05	10-11-58	40.00	S37-23-33E	20.08
78	225.00	58.47	14-53-23	58.30	S24-50-53E	29.40
79	275.00	68.65	14-18-14	68.48	N24-33-18W	34.51
80	275.00	87.83	18-17-54	87.45	N40-51-22W	44.29
81	275.00	100.08	20-51-06	97.53	N40-25-51W	50.60
82	50.00	59.32	60-00-00	59.00	S85-53-01W	30.00
83	50.00	100.00	34-32-45	98.52	S91-50-24W	50.11
84	275.00	86.27	17-58-41	85.94	N79-50-49W	43.50
85	275.00	70.19	14-37-27	70.00	S13-51-07W	35.29



NOTE: ALL LOTS TO HAVE A 5' DRAINAGE & UTILITY EASEMENT ALONG SIDE LOT LINES AND A 10' EASEMENT ALONG REAR LOT LINES, UNLESS SHOWN OTHERWISE ON THE DRAWING.
 ALL LOT CORNERS STAKED WITH IRON PINS.

FOR DEDICATION OF ROADS SEE GREENVILLE COUNTY RECORDS BOOK 1 PAGE 382
 27593
 Filed This Day of April 1981
 And Recorded Vol. 7-X Page 88 at 3:00 P.M.
 Register Means Conveyance Greenville County, S.C.

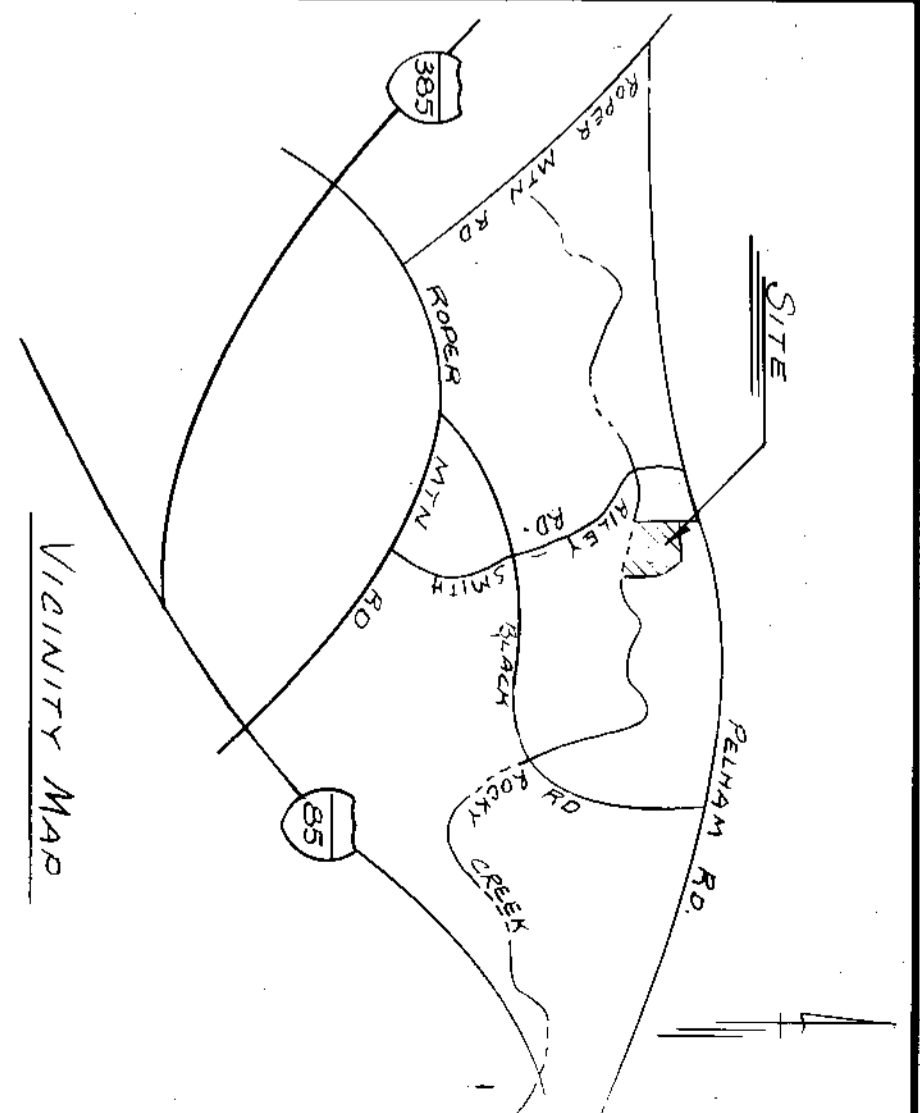

CERTIFICATE OF OWNERSHIP AND DEDICATION

The undersigned hereby acknowledge that I am (we are) the owner(s) of the property shown and described hereon and that I (we) hereby adopt this plan of subdivision with my (our) free consent and that I (we) establish the minimum building restriction lines, and hereby dedicate to public use as roads, streets, and easements, forever all lots 30 through 59 of the above and plat.

Signed _____
 Signed _____
 Signed _____

CERTIFICATE OF ACCURACY

I, MITCHELL W. BAKER certify that this plat was (drawn-by-me) (drawn under my supervision) (an actual survey made under my supervision) from (an actual survey made-by-me) (said description recorded in Book _____ Page _____ Book _____ Page _____ etc.) (other); that the error of closure as calculated by (latitudes and departures is 1:8000) that the boundaries not surveyed are shown as broken lines plotted from information found in Book _____ Page _____ that this plan was prepared in accordance with the Greenville County Subdivision Regulations as adopted

HEANER ENGR. CO., INC.
 M. W. Heaner
 LICENSED ENGINEER OR REGISTERED SURVEYOR
 DATE MAR. 13 1981

CERTIFICATE OF APPROVAL FOR RECORDING

I hereby certify that the subdivision plan shown hereon has been found to comply with the Subdivision Regulations for Greenville County, with the exception of such variances, if any, as are noted in the minutes of the Greenville County Planning Commission of Greenville County, South Carolina, and that it has been approved for recording in the office of the County Register of Means Conveyance.

Z. James Stiller
 DIRECTOR OF PLANNING
 GREENVILLE COUNTY PLANNING COMMISSION
 DATE 4/1/81

FILE NUMBER
80-146

BROOKFIELD WEST
 SECTION II

WOODFIELD LAND CO.
 GREENVILLE, S.C. HEANER ENGR. CO. INC.
 GREENWOOD, S.C. SURVEYOR

11-195-540-24-1
 NO. OF ACRES: 16.8
 MILES 0.4
 OUT OF 540-24-1-8.5

NO. OF LOTS: 34
 DATE: MAR. 13, 1981

SCALE: 1" = 100'
 100 50 0 100 200 300
 RECORDING FEE
 \$5.00